

Section 2 TEC FCNDK-FXA Helical Worm Gearbox

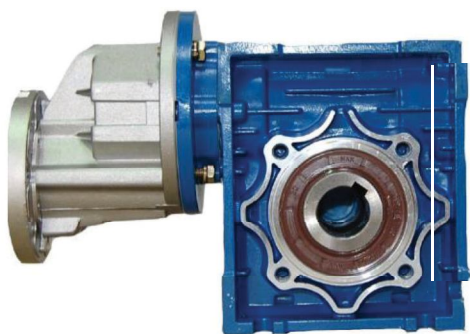

Summary

The helical gearboxes series FXA are manufactured as follows: aluminium die cast housing and covers, helical gears in alloy steel, case hardened, tempered and shaved. Gears - designed and verified according to ISO 6336 and DIN 3990 - and bearings are calculated for at least 15,000 running hour average life-time (assuming SF=1). Keyways according to DIN 6884.

Dimensions

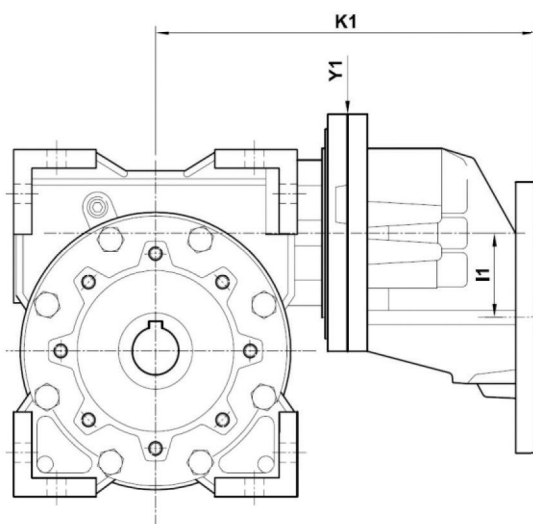

| Size | L1 | K1 | Y1 | Wt (kg) |
|-----------------|----|-----|-----|---------|
| FCNDK40/FXA63 | 32 | 153 | 105 | 3.8 |
| FCNDK50/FXA63 | 32 | 163 | 105 | 5.0 |
| FCNDK50/FXA71 | 40 | 170 | 120 | 5.7 |
| FCNDK63/FXA63 | 32 | 178 | 105 | 7.7 |
| FCNDK63/FXA71 | 40 | 185 | 120 | 8.4 |
| FCNDK63/FXA80 | 50 | 209 | 140 | 9.2 |
| FCNDK75/FXA71 | 40 | 203 | 120 | 11.2 |
| FCNDK75/FXA80 | 50 | 227 | 140 | 12.0 |
| FCNDK90/FXA71 | 40 | 220 | 120 | 15.2 |
| FCNDK90/FXA80 | 50 | 244 | 140 | 16.0 |
| FCNDK110/FXA80 | 50 | 274 | 140 | 38.0 |
| FCNDK110/FXA100 | 63 | 337 | 200 | 42.0 |
| FCNDK130/FXA100 | 63 | 357 | 200 | 55.0 |

| Size | Performance | | | Motor Input Options | | | | | |
|--------|-------------|------|-----|---------------------|----------|----------|----------|----------|-----------|
| | Ratio | KW | Nm | 56B14-B5 | 63B14-B5 | 71B14-B5 | 80B14-B5 | 90B14-B5 | 100B14-B5 |
| FXA63 | 3.53 | 0.50 | 12 | | | | | | |
| | 6.18 | 0.23 | 10 | | | | | | |
| | 7.77 | 0.18 | 9 | | | | | | |
| FXA71 | 3.53 | 1.10 | 26 | | | | | | |
| | 6.40 | 0.52 | 22 | | | | | | |
| | 8.00 | 0.37 | 20 | | | | | | |
| FXA80 | 3.42 | 3.10 | 68 | | | | | | |
| | 6.40 | 1.50 | 65 | | | | | | |
| | 8.30 | 1.10 | 60 | | | | | | |
| FXA100 | 3.88 | 8.70 | 235 | | | | | | |
| | 6.23 | 4.00 | 163 | | | | | | |
| | 8.40 | 2.20 | 136 | | | | | | |

The FXA gearboxes are delivered filled With synthetic long-life oil (without plugs) and in the appropriate quantity to install them in any mounting position without prior specification.



The Motor Control
Warehouse



The Motor Control
Warehouse